

RESOLUTION NO. 2020-01

RESOLUTION OF THE CITY OF SHELBYVILLE PLAN COMMISSION ASSIGNING A STREET NAME TO A PUBLIC WAY WITHIN THE CITY OF SHELBYVILLE

WHEREAS, the City of Shelbyville Plan Commission (the "Plan Commission") is the body charged with assigning street names, pursuant to Indiana Code 36-7-4-405(b)(1), and pursuant to City of Shelbyville Unified Development Ordinance 1.27 (A)(13); and

WHEREAS, the public right-of-way labeled "*Lot 6 (Right-of-Way)*" (the "Unnamed Right-of-Way") on the attached "*Final Plat Shelbyville Eastern Commerce Park Plat/Replat Krone Subdivision*" (the "Plat") has not been assigned a street name by the Plan Commission previously; and

NOW, THEREFORE, BE IT RESOLVED BY THE CITY OF SHELBYVILLE PLAN COMMISSION, THAT:

1. The Plan Commission hereby assigns the name of "Greenleaf Way" to the Unnamed Right-of-Way, shown on the attached Plat.

SO RESOLVED BY THE CITY OF SHELBYVILLE PLAN COMMISSION this 27th day of January 2020.

CITY OF SHELBYVILLE PLAN COMMISSION

President, Michael P. Evans

ATTEST:

Secretary, Adam M. Rude

**FINAL PLAT
SHELBYVILLE EASTERN COMMERCE PARK PLAT
/REPLAT KRONE SUBDIVISION**

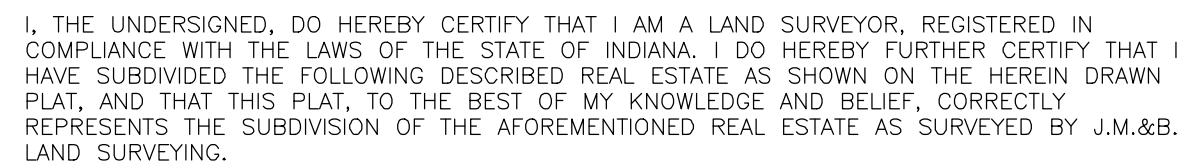

PART OF THE SECTION 34, TOWNSHIP 13 NORTH, RANGE 7 EAST AND PART OF THE NORTHEAST QUARTER OF SECTION 3, TOWNSHIP 12 NORTH, RANGE 7 EAST OF THE SECOND PRINCIPAL MERIDIAN, SHELBY COUNTY, INDIANA, DESCRIBED AS FOLLOWS:

BEGINNING AT THE SOUTHWEST CORNER OF THE SOUTHEAST QUARTER SECTION OF SAID SECTION 34; THENCE ALONG THE SOUTH LINE THEREOF NORTH 89 DEGREES 43 MINUTES 33 SECONDS EAST 607.26 FEET TO A POINT ON THE SOUTH LINE OF SAID SECTION 34; THENCE NORTHERLY AND WESTERLY ALONG THE BOUNDARY LINES OF SAID SECTION 34 AS RECORDED IN THE OFFICE OF THE RECORDER OF SHELBY COUNTY, INDIANA, THENCE ALONG THE EAST LINE OF SAID INSTRUMENT NUMBER NORTH 00 DEGREES 59 MINUTES 09 SECONDS WEST 1016.97 FEET; THENCE NORTH 50 DEGREES 57 MINUTES 12 SECONDS EAST 1016.97 FEET TO A POINT ON THE SOUTHWEST CORNER OF SAID SECTION 34; THENCE NORTH 75.5 FEET TO THE SOUTHERLY RIGHT-OF-WAY OF STATE ROAD 44 PER INSTRUMENT NUMBER 2006009424 AS RECORDED IN SAID RECORDER'S OFFICE; THENCE ALONG LAST SAID RIGHT-OF-WAY NORTH 61 DEGREES 14 MINUTES 32 SECONDS EAST 2053.31 FEET; THENCE ALONG THE SOUTHWEST CORNER OF SAID SECTION 34 NORTH 61 DEGREES 14 MINUTES 32 SECONDS EAST 1016.97 FEET TO THE SOUTHEAST QUARTER OF SAID SECTION 34; THENCE ALONG LAST SAID SOUTH LINE NORTH 89 DEGREES 43 MINUTES 33 SECONDS EAST 687.05 FEET TO THE SOUTHWEST CORNER OF SAID SECTION 34; THENCE SOUTH 89 DEGREES 43 MINUTES 33 SECONDS WEST 1016.97 FEET TO THE SOUTHWEST QUARTER SECTION NORTH 89 DEGREES 37 MINUTES 38 SECONDS EAST 416.76 FEET; THENCE SOUTH 00 DEGREES 33 MINUTES 29 SECONDS EAST 1237.79 FEET TO THE CENTER OF LEWIS CREEK, THE NEXT THIRTEEN (13) COURSES ARE ALONG THE CENTERLINE OF SAID LEWIS CREEK, BEING: 1) THENCE NORTH 15 DEGREES 15 MINUTES 15 SECONDS WEST 123.27 FEET; 2) THENCE NORTH 69 DEGREES 51 MINUTES 05 SECONDS WEST 75.68 FEET; 3) THENCE SOUTH 87 DEGREE 17 MINUTES 03 SECONDS WEST 177.67 FEET; 4) THENCE SOUTH 65 DEGREES 15 MINUTES 56 SECONDS WEST 76.32 FEET; 5) THENCE NORTH 66 DEGREES 26 MINUTES 58 SECONDS WEST 221.04 FEET; 6) THENCE SOUTH 57 DEGREES 21 MINUTES 22 SECONDS WEST 57.71 FEET; 7) THENCE NORTH 37 DEGREES 37 SECONDS WEST 136.98 FEET; 8) THENCE SOUTH 76 DEGREES 54 MINUTES 15 SECONDS WEST 109.37 FEET; 9) THENCE SOUTH 61 DEGREES 19 MINUTES 18 SECONDS WEST 121.23 FEET; 10) THENCE SOUTH 26 DEGREES 54 MINUTES 17 SECONDS WEST 62.45 FEET; 11) THENCE SOUTH 05 DEGREES 32 MINUTES 35 SECONDS EAST 85.00 FEET; 12) THENCE SOUTH 34 DEGREES 41 MINUTES 50 SECONDS WEST 136.21 FEET TO THE NORTHERLY RIGHT-OF-WAY OF INTERSTATE 74 ((=PROJECT NO. 05-3 (26) AND I-PROJECT NO. 74-3 (26)). SAID POINT ALSO BEING ON A CURVE CONCAVE SOUTHWESTERLY THE RADIUS POINT OF SAID CURVE BEARS SOUTH 38 DEGREES 44 MINUTES 44 SECONDS WEST 1159.16 FEET, THE NEXT THREE (3) COURSES ARE ALONG LAST SAID RIGHT-OF-WAY BEING: 1) THENCE ALONG THE CENTRAL ANGLE OF 05 DEGREES 09 MINUTES 19 SECONDS 1235.24 FEET; 2) THENCE NORTH 57 DEGREES 36 MINUTES 30 SECONDS WEST 1071.98 FEET TO A CURVE CONCAVE NORTHEASTERLY THE RADIUS POINT OF SAID CURVE BEARS NORTH 34 DEGREES 41 MINUTES 18 SECONDS EAST 1300.00 FEET; 3) THENCE ALONG THE CENTRAL ANGLE OF 01 MINUTE 09 SECONDS 541.24 FEET TO THE SOUTH LINE OF THE SOUTH LINE OF THE SOUTHWEST QUARTER OF SAID SECTION 34; THENCE ALONG SAID SOUTH LINE NORTH 89 DEGREES 50 MINUTES 17 SECONDS EAST 226.06 FEET TO THE POINT OF BEGINNING CONTAINING ABOUT 200 ACRES MORE OR LESS SUBJECT MATTER SET-FORTH BY THE EASEMENTS AND RESTRICTIONS;

SUBDIVISION CONSISTS OF SIX LOTS, NUMBERED 1 THROUGH 6, TOGETHER WITH EASEMENTS AND PUBLIC WAYS AS SHOWN HEREON.

THIS PLAT IS BASED ON A SURVEY RECORDED IN FILE ____ PAGE _____ IN THE OFFICE OF THE RECORDER OF SHELBY COUNTY, INDIANA. THERE HAS BEEN NO CHANGE FROM THE MATTERS OF SURVEY, OR ANY PRIOR SUBDIVISION PLAT CONTAINED THEREIN, ON ANY LINES THAT ARE COMMON WITH THIS SUBDIVISION.

SURVEY CERTIFICATION

STATE OF INDIANA SS:

COUNTY OF SHELBY

I, JEFFREY D. KNARR HEREBY CERTIFY THAT I AM A PROFESSIONAL SURVEYOR LICENSED IN COMPLIANCE WITH THE LAWS OF THE STATE OF INDIANA, AND I DO HEREBY FURTHER CERTIFY THAT I HAVE SURVEYED THE PROPERTY, DESCRIBED IN THE ABOVE CAPTION PLAT ON JUNE 18, 2016, AND OTHER DATES. FURTHERMORE THIS SURVEY CONFORMS WITH 865 IAC 1-12-19.

DATED THIS _____ DAY OF _____, 2019.

SIGNATURE 
JEFFREY D. KNARR
PROFESSIONAL SURVEYOR #20100069



NOTE:

PRIVATE BLANKET EASEMENT OVER AND ACROSS LOT 4 IS RESERVED FOR THE BENEFIT OF LOT 2 FOR SURFACE WATER DRAINAGE AND USE OF THE DETENTION POND.

ALL RIGHT-OF-WAY SHOWN AND NOT HERETOFORE DEDICATED ARE HEREBY
DEDICATED TO THE PUBLIC.

CERTIFICATE OF OWNERSHIP

I, _____, OWNERS OF THE PROPERTY DESCRIBED IN THE ABOVE CAPTIONED, DO HEREBY CERTIFY THAT WE CAUSED THE SAID ABOVE DESCRIBED PROPERTY TO BE SURVEYED AND SUBDIVIDED AS SHOWN ON THE HEREON DRAWN PLAT, AS OUR OWN FREE AND VOLUNTARY ACT AND DEED.

DATED THIS _____ DAY OF _____, 2019.

SIGNATURES: _____

STATE OF INDIANA)
) SS
COUNTY OF _____

I, _____, A NOTARY PUBLIC IN AND FOR SAID COUNTY AND STATE, DO HEREBY
CERTIFY THAT _____ PERSONALLY KNOWN TO ME TO

BE THE SAME PERSONS WHOSE NAMES ARE SUBSCRIBED TO THE ABOVE CERTIFICATE APPEARED BEFORE ME THIS DAY IN PERSON AND ACKNOWLEDGE THAT THEY SIGNED THE ABOVE CERTIFICATE AS THEIR OWN FREE AND VOLUNTARY ACT AND DEED FOR USES AND PURPOSES THEREIN SET FORTH.

GIVE UNDER MY HAND AND NOTORIAL SEAL THIS _____ DAY OF _____, 2019.

SIGNATURE _____
_____, NOTARY PUBLIC

MY COMMISSION EXPIRES: _____

MY COMMISSION EXPIRES: _____
COUNTY OF RESIDENCE: _____



Know what's below.
Call before you dig.

"IT'S THE LAW"
CALL 2 WORKING DAYS BEFORE YOU DIG

THIS DRAWING/COMPUTER FILE IS THE PROPERTY OF J.W.A.B. LAND SURVEYING
ANY REPRODUCTION OR REUSE OF THIS DOCUMENT WITHOUT WRITTEN
PERMISSION FROM J.W.A.B. LAND SURVEYING IS PROHIBITED. ANY PERSON OR ENTITY
USING THIS DOCUMENT FOR ANY PURPOSE OTHER THAN THE PROJECT
FOR WHICH IT WAS ORIGINALLY INTENDED, WITH OR WITHOUT PERMISSION
FROM J.W.A.B. LAND SURVEYING, BY ITS USE AGREES TO INDEMNIFY AND HOLD
HARMLESS J.W.A.B. LAND SURVEYING FROM ANY LOSS, INCLUDING BUT NOT LIMITED
TO ATTORNEY'S FEES, OCCURRING FROM THEIR USE.

PROJECT		SCALE	SYMBOL	REVISION	DATE
Krone Subdivision City of Shelbyville, Indiana		1"=200'			
TITLE		DRAWN			
PRELIMINARY PLAT		KW			
		CHECKED			
		JDK			
		CERTIFIED			
		JDK			

SEAL

WORK ORDER NUMBER
150181

SHEET
1

OF **ONE** SHEETS

DATE
APRIL 5, 2015